



Manufactured By: 

DISCOVER

MODERN STYLE GARAGE DOORS

CONTEMPORARY DESIGNS FOR THE MODERN HOME



PenguinGarageDoors.ca



PenguinGarageDoors@gmail.com



647-621-3331

3650

INSULATED SANDWICH



Flush Panel 3 Layer Sandwich

FLUSH PANELS



↑ GRAY | RANCH WINDOWS

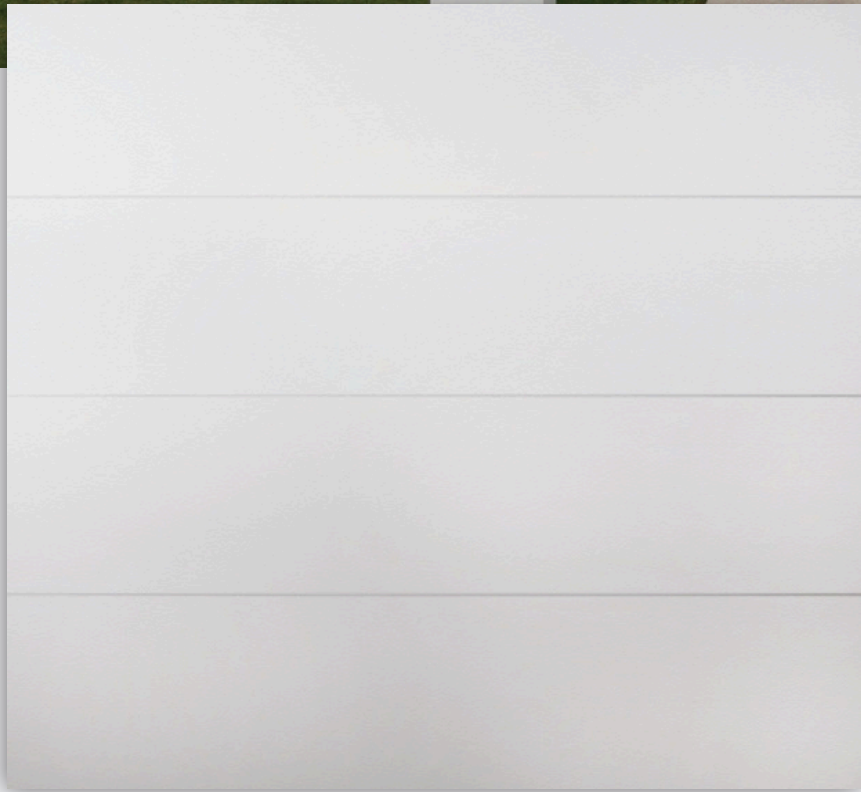

Flush Panel

2" thick insulated steel sandwich panel constructed of top quality materials. Flush panel with deep woodgrain texture and two coat prefinished paint system all combine to enhance the beauty of your home.

- 2" thick insulated 3 layer sandwich panel
- 1.0 mil paint with 7 color options
- R-value 10.25
- Steel interior skin

↑ WHITE



WHITE



ALMOND



DESERT TAN

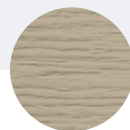

SANDSTONE

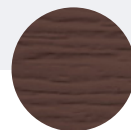

BROWN

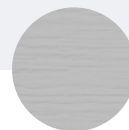

GRAY



BLACK

**Colors may vary from actual product*

FEATURES



26 GAUGE STEEL

Hot dipped galvanized steel construction with hemmed inside return rail provides superior strength and durability.



ROLLED SAFETY EDGES ON SECTION JOINTS

Eliminates sharp edges, and provides extra strength.



20 GAUGE HOT DIPPED STEEL HINGE PLATES

Galvanized steel hinge plates run the full height of each section at all hinge locations to facilitate the attachment of hinges, handles, struts, and step plates.



TONGUE AND GROOVE MEETING RAILS

For superior strength and better sealing against wind, rain, and snow.



RIGID ALUMINUM RETAINER WITH WEATHERSTRIP

Provides added strength while securing replaceable U-type bottom astragal weatherstrip to help keep the elements out.



10.25

R-VALUE 10.25

Sandwich type construction with polystyrene insulation pressure bonded between two sheets of hot dipped galvanized steel enhances your home's energy savings, makes your door operation quieter, and reduces exterior noise in your garage.



CFC FREE EXPANDED POLYSTYRENE

Environmentally friendly insulation that will not degrade with vibration or time.



↑ SANDSTONE

PAINT LAYERS

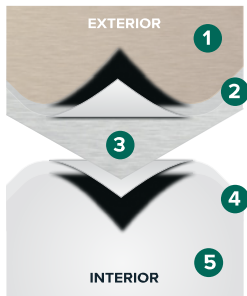

1.0 MIL PAINT SYSTEM

Includes .25 mil rust inhibiting primer and .75 mil exterior top coat that resists fading and chalking, while providing consistent color from panel to panel and more durability.

- 1 Paint - .75 MIL
- 2 Primer - .25 MIL
- 3 Steel
- 4 Primer - .2 MIL
- 5 Paint - .3 MIL

CONSTRUCTION

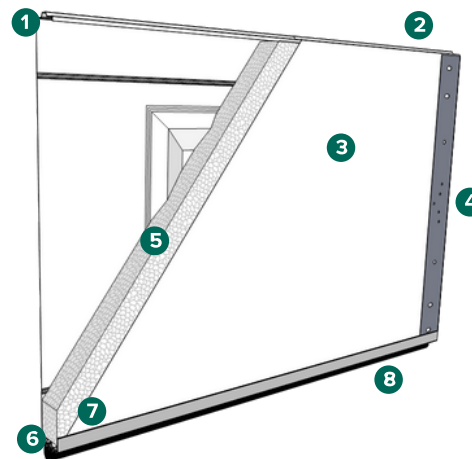

- 1 Tongue and groove meeting rails
- 2 2" thick section
- 3 Pebble grain embossed interior backskin
- 4 20 gauge hot dipped galvanized steel end caps
- 5 CFC free expanded polystyrene insulation
- 6 Replaceable U-Type vinyl bottom weatherstrip
- 7 20 gauge full vertical steel hinge plate for hardware attachment
- 8 Extruded aluminum weatherstrip retainer

WINDOW OPTIONS

Contact your supplier for window options

WINDOW GLASS OPTIONS

Contact your supplier for glass options

SIZE OPTIONS

WIDTHS:

8', 9', 10', 12', 14', 15', 16', 17', 18', 20', 22', 24'

HEIGHTS:

6'6", 6'9", 7'0", 7'6", 7'9", 8'0"

FLUSH PANELS

Ozark Series

3700 | 3 LAYER, INSULATED SANDWICH



Manufactured By: *doorLink*
Manufacturing, Inc.



↓ PLANK CYPRESS

Ozark Series

3700 | 3 LAYER, INSULATED SANDWICH

FLUSH PANELS

Ozark Series showcases the look and appearance of real wood, with the deep woodgrain embossment, reliability, and durability you have come to expect with doorLink doors.

PANEL HIGHLIGHTS:



26 GAUGE STEEL

Hot dipped galvanized steel exterior and interior skins to provide superior strength and durability.



20 GAUGE HOT DIPPED STEEL HINGE PLATES

Galvanized steel hinge plates run the full height of each section at all hinge locations to facilitate the attachment of hinges, handles, struts, and step plates.



2" THICK INSULATED 3 LAYER SANDWICH PANEL

2" thick insulated steel sandwich panel constructed of top quality materials. Ozark Series offers a deep woodgrain texture and two coat prefinished paint system all combine to enhance the beauty of your home.



R-VALUE 10.25

Sandwich type construction with polystyrene insulation pressure bonded between two sheets of hot dipped galvanized steel enhances your home's energy savings, makes your door operation quieter, and reduces exterior noise in your garage.



WINDOWS

Check with your supplier for more information.

↓ PLANK DRIFTWOOD



↓ PLANK CYPRESS



↓ PLANK WALNUT

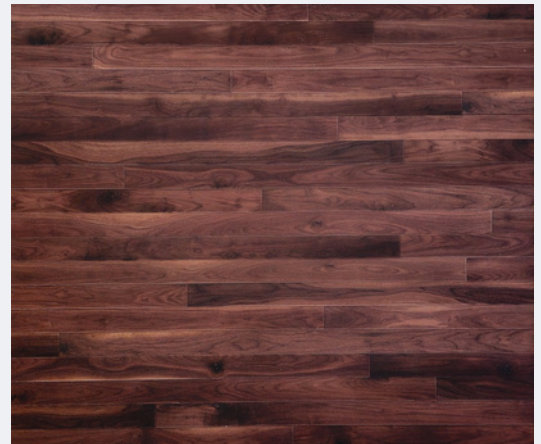

*Colors may vary from actual product

PLANK DRIFTWOOD ↓



647-621-3331
PenguinGarageDoors@gmail.com
PenguinGarageDoors.ca

Manufactured By: **doorLink**
Manufacturing, Inc.®

8000



Manufactured By: **doorLink** Manufacturing, Inc.

Premium Aluminum Full View Panel

COMMERCIAL/RESIDENTIAL



BRONZE POWDER COATED WITH CLEAR GLASS ↑

↑ CLEAR ANODIZED WITH SATIN GLASS

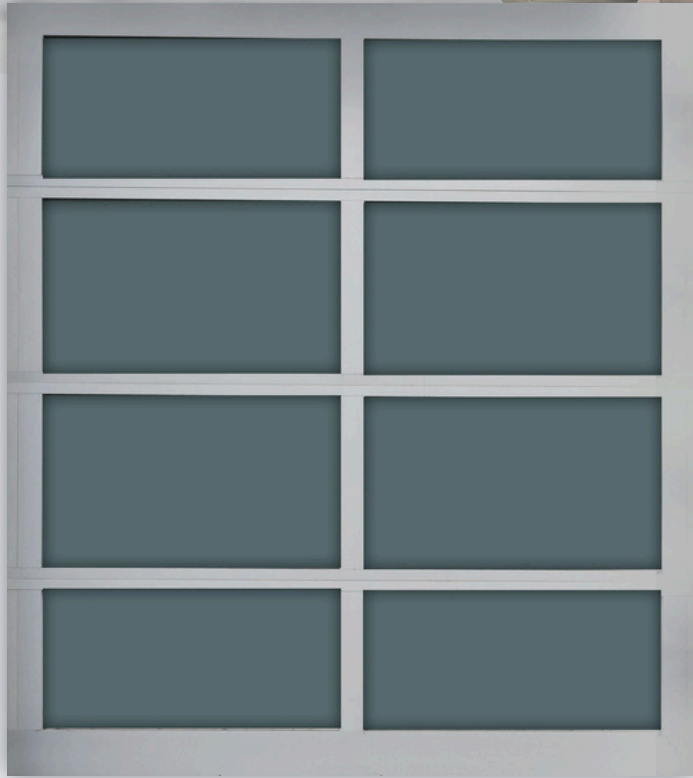

↑ CLEAR ANODIZED WITH SATIN GLASS

Premium Aluminum Full View Panel

The right choice when maximum light and visibility are required. Ideally suited for all residential, commercial, and retail establishments. Choose from a variety of glazing options including glass, acrylic, insulated glass, or aluminum panels.

- 1/8" glass or acrylic **8100 Feature*
- 1/4" glass **8400 Feature*
- 1/2" insulated glass **8500 Feature*



CLEAR ANODIZED



WHITE POWDER COATED



BRONZE POWDER COATED



BLACK POWDER COATED

**Colors may vary from actual product*

FEATURES



DOOR SECTIONS

Door sections are 2" thick and consist of extruded aluminum rails and stiles assembled with 5/16" threaded rods and nuts. Glazing is sealed on all four sides and retained on all four sides with extruded aluminum snap-in beads. The end stiles have a visible width of 3 3/8". Center stiles have a visible width of 2 3/4". Top rail has a visible height of 4 1/4". Bottom rail has a visible height of 4 1/4" or 7 1/4" depending on door size and weight.

Combined meeting rails have a visible height of 2 1/2". Lower meeting rail has an integral reinforcing fin on doors over 12' 2" wide (Model 8100) or over 10' 2" wide (Models 8400 and 8500).



FINISH

All aluminum parts are clear anodized, bronze powder coated, white powder coated, or black powder coated. Powder coated in custom colors available.



RIGID ALUMINUM RETAINER WITH WEATHERSTRIP

Provides added strength while securing replaceable U-type bottom astragal weatherstrip to help keep the elements out.



GLAZING

Sections can be glazed with 1/8" glass or acrylic (Model 8100), 1/4" glass (Model 8400), or 1/2" insulated glass (Model 8500). Many glazing options are available including tempered glass, tinted glass, low E glass, or laminated safety glass. 0.062" anodized aluminum panels can be used in any section.



WIND LOAD

Consult factory for available wind load rated options.

SIZE OPTIONS

WIDTHS:

UP TO 9'2"	<input type="checkbox"/>	<input type="checkbox"/>				
9'3" TO 12'2"	<input type="checkbox"/>	<input type="checkbox"/>	<input type="checkbox"/>			
12'3" TO 17'2"	<input type="checkbox"/>	<input type="checkbox"/>	<input type="checkbox"/>	<input type="checkbox"/>		
17'3" TO 18'2"	<input type="checkbox"/>	<input type="checkbox"/>	<input type="checkbox"/>	<input type="checkbox"/>	<input type="checkbox"/>	
18'3" TO 20'2"	<input type="checkbox"/>	<input type="checkbox"/>	<input type="checkbox"/>	<input type="checkbox"/>	<input type="checkbox"/>	<input type="checkbox"/>

HEIGHTS: 21", 24"

WINDOW OPTIONS



1/8" Glass



1/4" Glass



1/2" Insulated Glass

WINDOW GLASS OPTIONS

Contact your supplier for window options

CONSTRUCTION

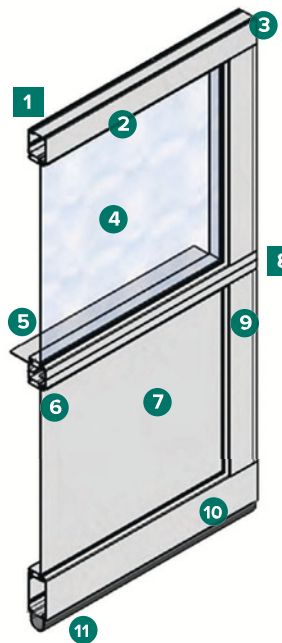

- 4-1/4" Full tubular top rail
- Aluminum components are clear anodized, bronze powder coated, white powder coated, or black powder coated; powder coated in custom colors on request
- 2" thick sections
- Large glass panels allow maximum light and visibility; glass thicknesses from 1/8" to 1/2"
- 2-1/8" integral reinforcing fin on lower meeting rail for doors over 12'-2" wide (Model 8100) or over 10'-2" wide (Models 8400 and 8500)
- Glass and aluminum panels retained with extruded aluminum snap in bead
- 0.062" aluminum panels finish to match aluminum frame; aluminum panels can be provided in all sections
- 2-1/2" combined meeting rails
- 3-3/8" full tubular end stile
- Full tubular bottom rail; 4-1/4" or 7-1/4" depending on door size and weight
- Replaceable flexible vinyl bottom weatherstrip